

Thermostatic head DTW



- Available in white and chrome
- Dimension: M30x1,5
- Accurate
- Temperature: 9°C to +29°C
- Including adapter M28x1,5

Description *DTW*

Area of use

Thermostatic head DTW is used to regulate valves for heating and cooling systems. For example radiators, cooling systems and towelwarmers.

Description

DTW is a self-acting adjustable thermostatic head designed to achieve best possible temperature regulation function.

The symbol * means frost protection, and are used in rooms that will have a lower temperature.

DTW has a connection that is M30x1,5, but is delivered with an adapter for MMA by purmo valves.

The thermostatic head is also available in chrome.

DTW is approved under EN215 in combination with FVR10, FVR15 and FVV15.



Description *DTW*

Technical data

Setting range

9-29°C

Hysteresis

1K max

Water temperature influence

1,4K

Differential pressure influence

0,6K

Response time

27 minuter

Mark

EN215

Material

Brass, Polyamid

Vikt

86 g

Measurements

	A	A1	B	C	D
DTW	78	15	43,5	M30x1,5	M28x1,5

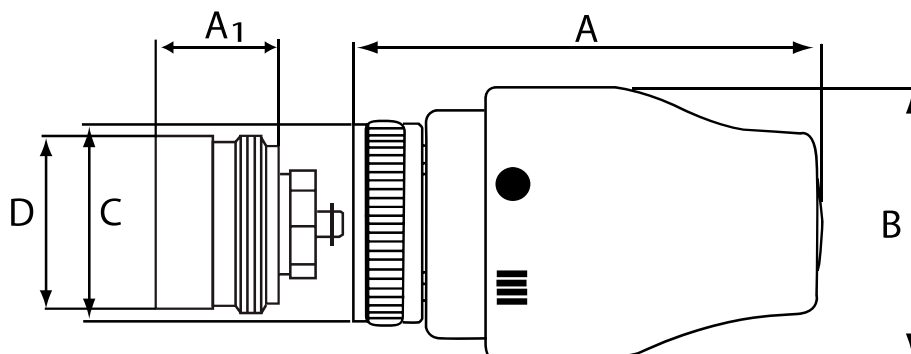

Description *DTW*

Temperature range

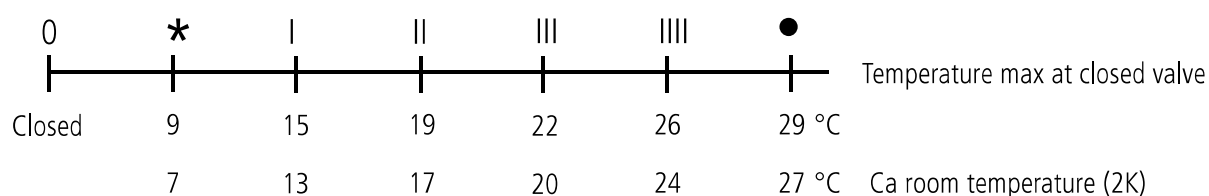

Note! The room temperature will be about 1-2 °C lower than the set value.

Ordering codes

Article number	Designation	Description
FD0T50M3000B29SE0	DTW-30	White 9-29 °C standard
FD0T50M3000B29SESCHRO	DTW-30 cr	Chrome 9-29 °C



We reserve the right to alter information without notice