

Purmo Group Sweden AB  
Tel. +46 (0)433 737 00

4 8282 99  
200813 rev.2

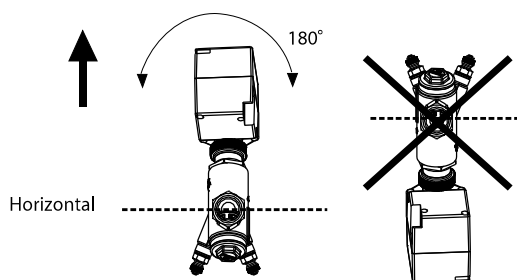

**2** Montering  
Mounting



**1** Standardapplikation  
Standard application

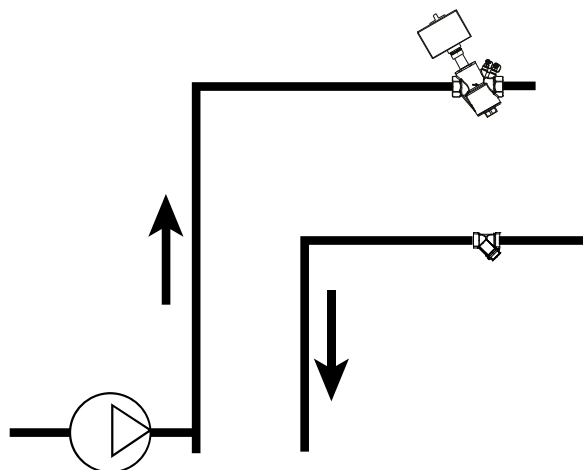

Kan monteras både på tillopp och retur. Vi rekommenderar att man även monterar smutsfilter och avstängningsventil. Temperaturen runt ställdonet bör inte vara under 0°C. TOV kan endast användas som avstängningsventil då trycket kommer i pilens riktning.

Can be mounted in either the supply or the return line. Installation of strainers and isolation ball valves are recommended. The temperatur in and about the actuator should not be below 0°C. TOV can only be used as a shut-off valve when the pressure is in the direction of the arrow.

**4** Förinställning  
Pre-setting

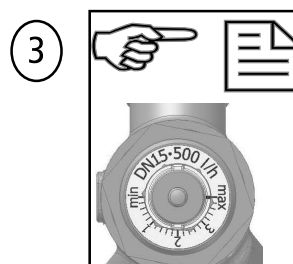
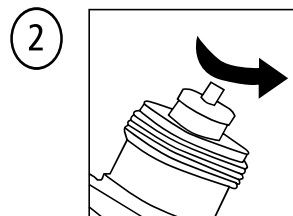
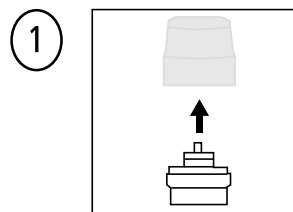

### TOV DN50

