

Godkänd enligt EN215 tillsammans med/ Approved under EN215 in combination with/ Geprüft nach EN215 in kombination mit/ Approuvé selon EN215 avec/ Godkendt iht. EN215 sammen med FVR10, FVR15, FVV15.
Hyväksyty EN215 Mukaan FVR10, FVR15, FVV15 kanssa.
/ Utilizat conform EN 215, în combinație cu FVR10, FVR15, FVV15.

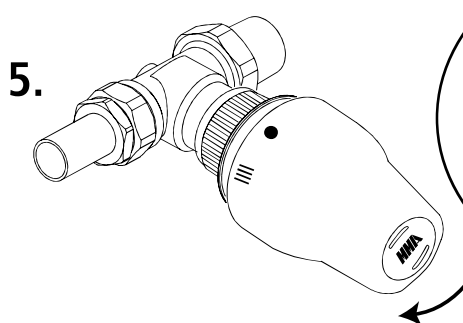
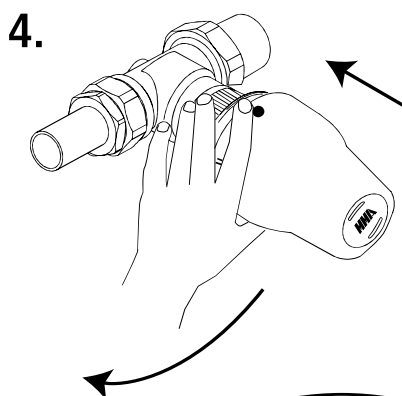
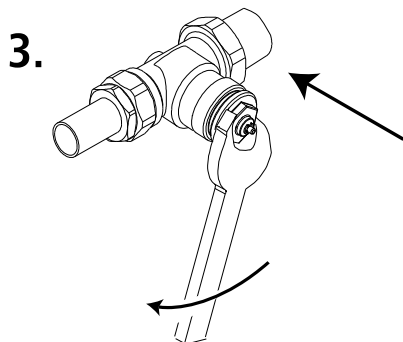
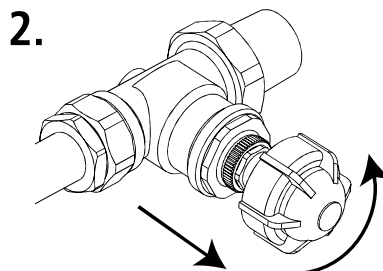
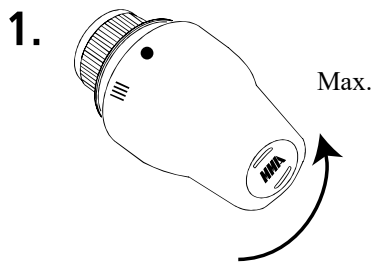

Ställ in önskad temperatur.
Set temperature desired.
Gewünschte Temperatur einstellen.
Tourner pour choisir la température.
Aseta haluttu lämpötila.
Indstil ønsket temperatur.
Setați temperatura dorită.

Stängd
Closed
Geschlossen

0	*	I	II	III	IIII	•
Fermée	9	15	19	22	26	29 °C
Kiinni	7	13	17	20	24	27 °C
Lukket						
Închis						

Temp. vid stängd ventil
Temp. when valve is closed
Temp. bei geschl. Ventil
Temp. à vanne fermée.
Lämpötila, kun venttiilion kiinni.
Temp. ved lukket ventil
Temp.când robinetul se închide
Ca rumstemp. / room temp. / Raumtemp.
température de la pièce / Huonelämpötila
Ca. rumtemp./Temp.în cameră
(2K)