

Refurbishment valve NAF S65, RFA 59



- Adjustable 1-2-pipe
- Bottom-coupled
- c/c 60
- Temperature: 5°C till +100°C
- Pressure class: PN 10

Description *RFA 59*

Area of use

RFA 59 replaces NAF S65 1- or 2-pipe valves bottom-coupled
The valves can be regulated with a thermostat or handwheel M28x1.5.

Description

RFA 59 has a hidden preset under the stuffing box.
Pre-setting of 2-pipe system is done with key FN2 or presetting tool FV5.
The valve has connection M22x1.5 to the pipe network.
The connection to the radiator is M22x1.5.
RFA 59 is adjustable from 1- to 2-pipe systems (delivered set as 1-pipe).
With the by-pass valve you can set the distribution of the flow to the radiator.

Adjustment

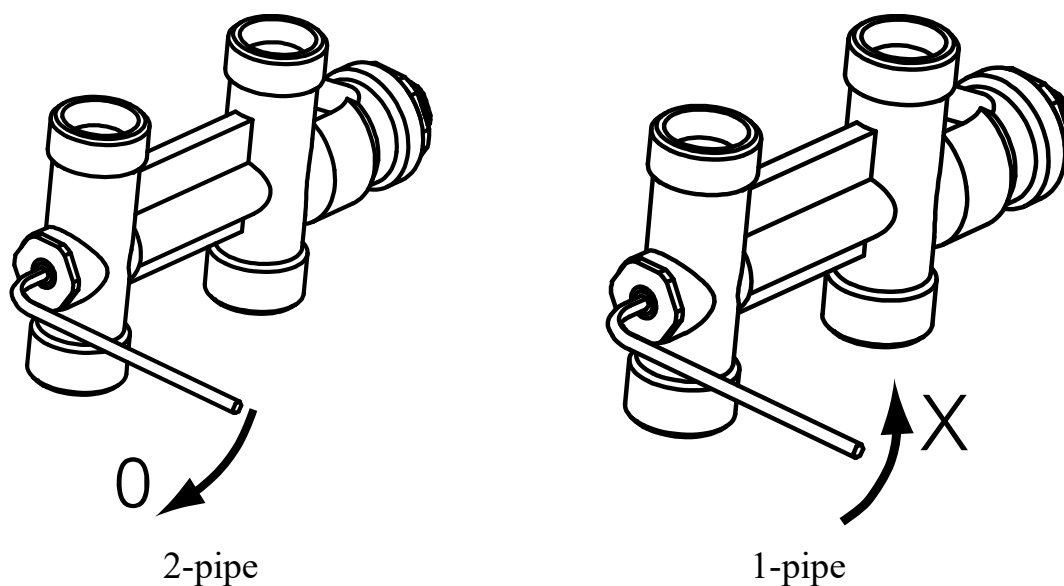

Description *RFA 59*

Pre-setting FN 2 key

The valve is equipped with an insert that has a hidden preset.

Unscrew the protective knob. Remove the stuffing box with pins (use the top on preset key FN2)

Insert the preset key with the knurled end into the throttle sleeve and carefully screw this (clockwise) at the bottom.

Unscrew the number of turns indicated according to the diagram.

Refit the stuffing box with pins.



Pre-setting FV5

- Remove the protective knob and stuffing box as above.
- Screw down the throttle sleeve at the bottom as above.
- Remove the preset key and mount it on the preset tool over the lightened insert, and put the preset key back through the device.
- Reset the scale to the index mark.
- Unscrew the throttle sleeve so that the desired Kv value coincides with the index marking.
- Refit the stuffing box with pins.

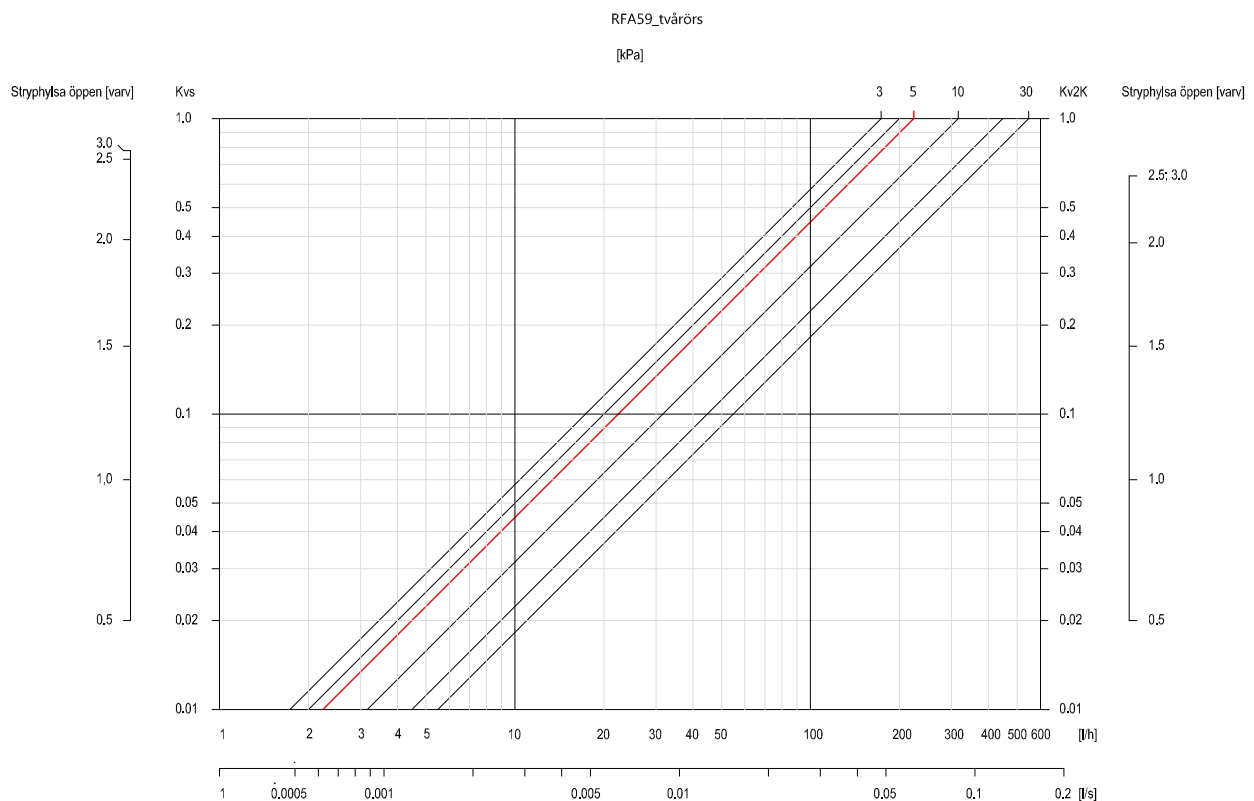

Technical data *RFA 59*



Pressure class

PN 10

Min temperature

5°C

Max temperature

100°C

Maximum differential pressure / closing pressure

150 kPa

At 2-pipe

Kv value / KVS value

0,01-0,7/0,01-0,78

Material

Brass

Gaskets EPDM

Weight

338 g

1-pipesystem

Kv_{2K}

(Valve preset fully open)

open turns X Bypass	Kv total	Kv radiator	% radiator
1	0,86	0.65	76
2	1.14	0.64	56
3	1.49	0.60	40
4	1.90	0.56	30
5	2.29	0.49	21
6	2.57	0.44	17

Kv_S

(Valve preset fully open)

open turns X Bypass	Kv total	Kv radiator	% radiator
1	0,97	0.77	79
2	1.23	0.76	62
3	1.61	0.71	44
4	2.01	0.65	32
5	2,32	0.56	24
6	2.59	0.49	19

Product information *RFA 59*

Measurements

	A	B	c/c	Weight
RFA 59	64	127	c/c 60	338g

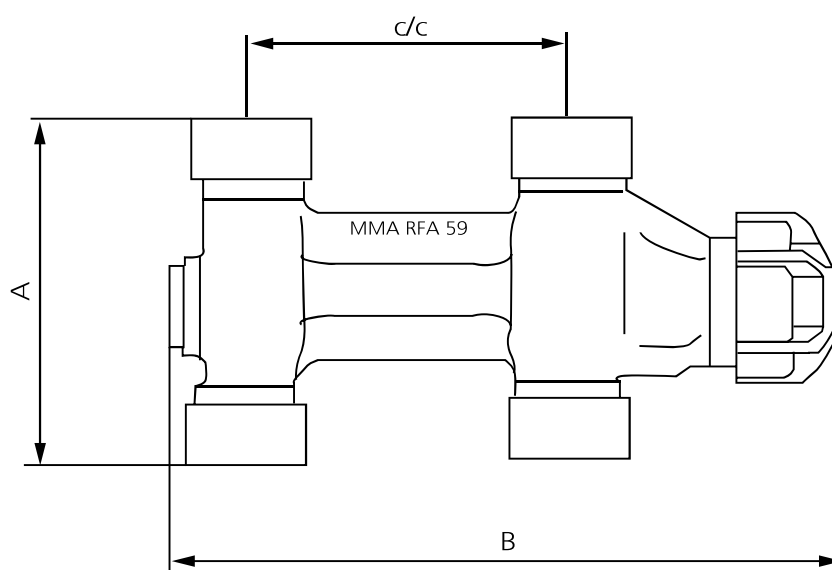

Ordering codes

RSK-number	Article-number	Designation	Description
480 63 30	FD4R1001200X00SE0	RFA 59	Etthålsventil växelbar 1-2 rörs M22x1,5

