

FVRF/FVVF

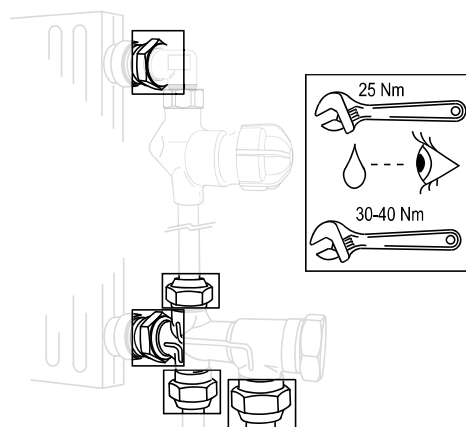
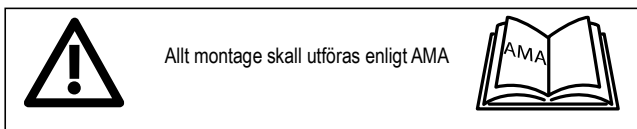
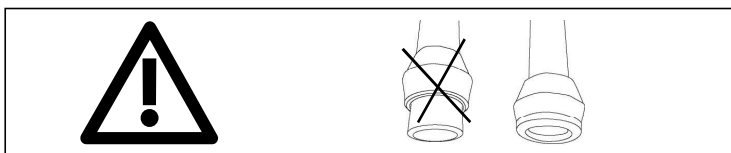
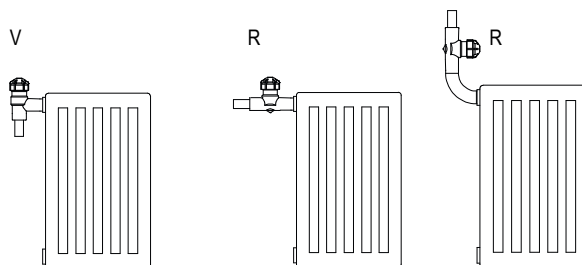
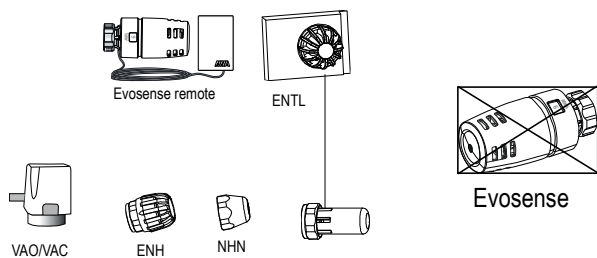
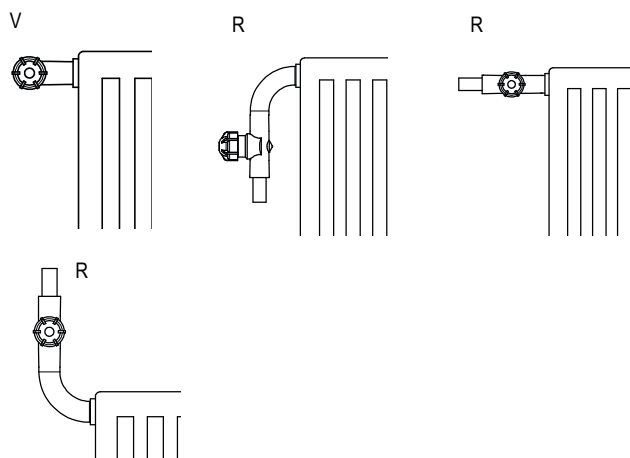
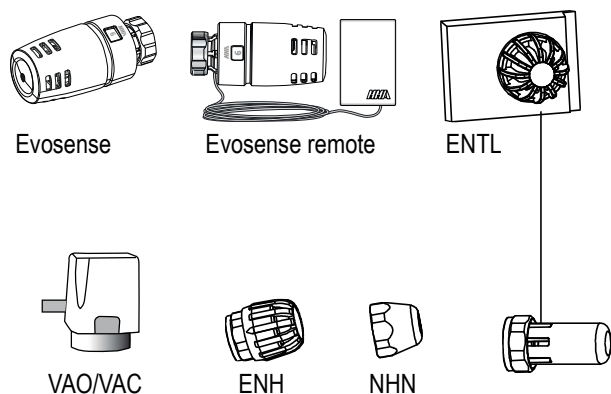
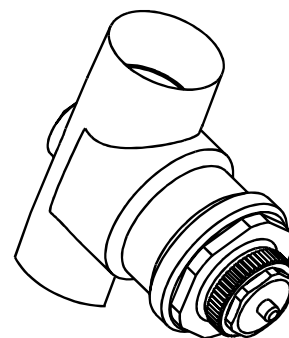
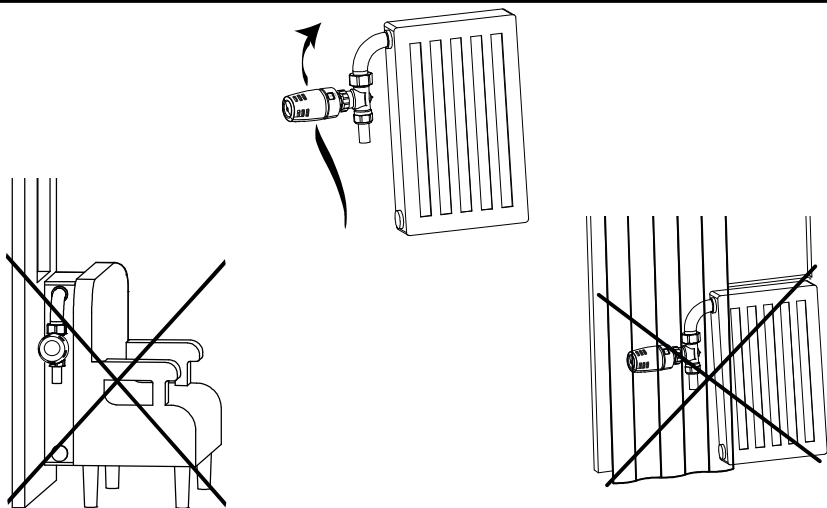

Kan även installeras i kylanläggning, men endast i kombination med VAO / VAC.
 Can also be installed in refrigerating plants, but only combined with VAO / VAC.
 Kann auch in Kuhl Anlagen installiert werden, jedoch nur in Kombination mit VAO / VAC.
 Peut aussi être monté dans une installation de refroidissement, mais seulement en combinaison avec VAO / VAC.
 Venttiiliä voidaan käyttää myös jäähdytysjärjestelmissä, mutta varustettuna toimilaitteella VAO / VAC.
 Kan også installeres i køleanlæg, men kun i kombination med VAO / VAC.

Förinställning, Pre setting, Voreinstellung, Préréglage, Esisäätö Forindstilling

FVRF, FVVF

Öppningsvarv **N** gäller för:
Turns open **N** valid for:
Öffnungsumdrehungen **N** gilt für:
Tours d'ouverture **N** concernent:
Avauskerrokset **N**:
Äbningsomdrejning **N** gælder for:

KVS



Alt.1

Öppningsvarv **N** gäller för:
Turns open **N** valid for:
Öffnungsumdrehungen **N** gilt für:
Tours d'ouverture **N** concernent:
Avauskerrokset **N**:
Äbningsomdrejning **N** gælder for:

Kv 2K

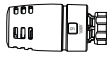

Alt.2

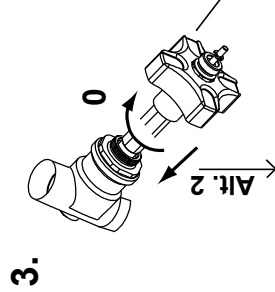
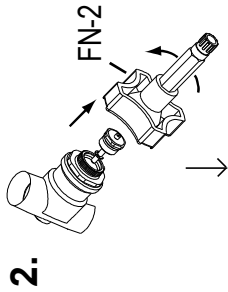
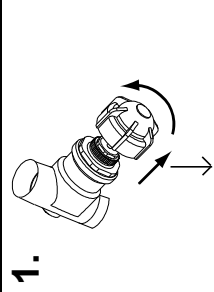
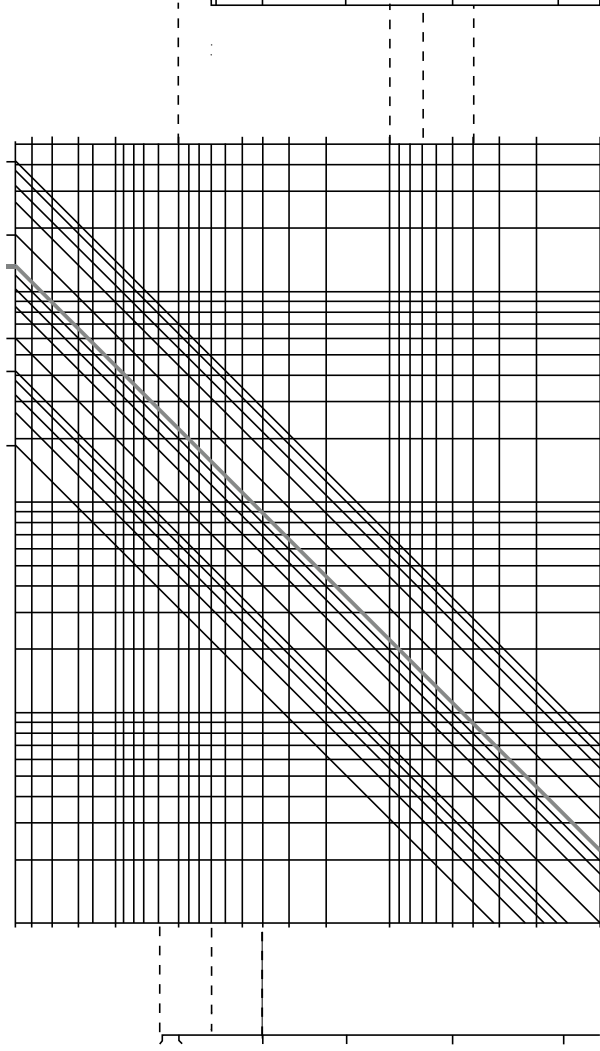

Inställning med verktyg FV gäller endast 2K.
Setting by means of the FV tool only valid for 2K.
Voreinstellung mit Werkzeug FV gilt nur für 2K.
Réglage à l'aide de l'outil FV valable seulement pour 2K.
FV esisäätöväkalua käytetään vain 2K.
Indstilling med værktøjet FV gælder kun for 2K.

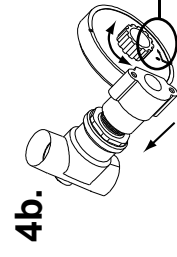
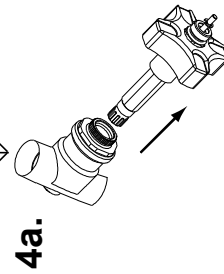

Nollställ
Turn to zero
Nullstellung
Mettre à zero
Aseta näyttötaulu nolnaan
Nulstil

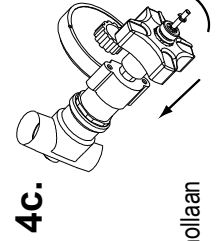

Ställ in Kv
Set Kv
Einstellung Kv
Afficher Kv
Aseta haluttu Kv
Indstil Kv

